

## MELTING FURNACE Over metal level

Pasek INSU 15/25/45 C	<input type="checkbox"/>	<input type="checkbox"/>	<input type="checkbox"/>
Pasek 65 G	<input type="checkbox"/>	<input type="checkbox"/>	<input type="checkbox"/>
Pasek 80 C	<input type="checkbox"/>	<input type="checkbox"/>	<input type="checkbox"/>
Pasek FD 85 C	<input type="checkbox"/>	<input type="checkbox"/>	<input type="checkbox"/>

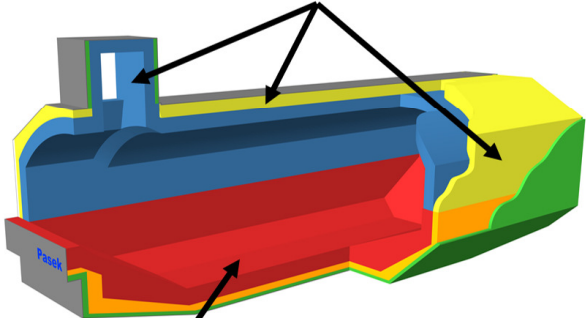

## MELTING FURNACE Under metal level

Pasek INSU15/25/45 B G	<input type="checkbox"/>	<input type="checkbox"/>	<input type="checkbox"/>
Pasek 80 B C	<input type="checkbox"/>	<input type="checkbox"/>	<input type="checkbox"/>
Pasek FD 85 B C	<input type="checkbox"/>	<input type="checkbox"/>	<input type="checkbox"/>

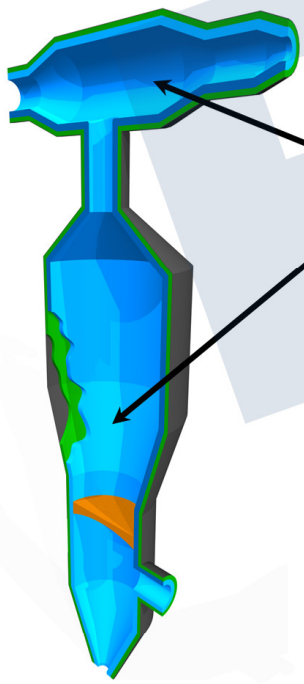

## SLC UNIT / DIGESTION CALCINER & MIXING CHAMBER

Pasek INSU 15/25/45 C/G	<input type="checkbox"/>	<input type="checkbox"/>	<input type="checkbox"/>
Pasek 85 S	<input type="checkbox"/>	<input type="checkbox"/>	<input type="checkbox"/>
Pasek 80 C	<input type="checkbox"/>	<input type="checkbox"/>	<input type="checkbox"/>
Pasek 80 HR C	<input type="checkbox"/>	<input type="checkbox"/>	<input type="checkbox"/>

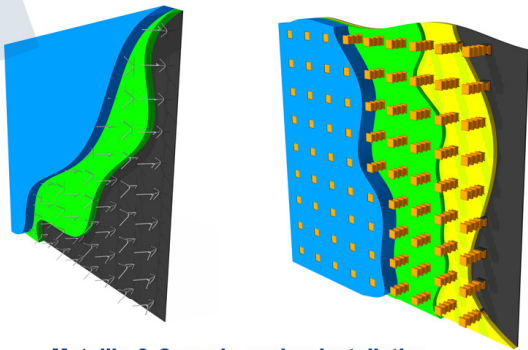

Metallic & Ceramic anchor installation

Insulating	Aluminous Castable	Conventional Castable
Gunning / Shotcrete	Silicon Carbide Cast.	Fast Dry Castable
Castable		

Aluminous Castable	Conventional Castable
Silicon Carbide Cast.	Fast Dry Castable

Conventional Castable	Fast Dry Castable
-----------------------	-------------------

## Alumina

### CALCINATION UNIT FURNACES, TANKS, CYCLONS & DUCTS

Pasek INSU 15/25/45 C/G	<input type="checkbox"/>	<input type="checkbox"/>	<input type="checkbox"/>
Pasek 85 S	<input type="checkbox"/>	<input type="checkbox"/>	<input type="checkbox"/>
Pasek 80 C	<input type="checkbox"/>	<input type="checkbox"/>	<input type="checkbox"/>
Pasek 80 HR C	<input type="checkbox"/>	<input type="checkbox"/>	<input type="checkbox"/>
Pasek 85 P	<input type="checkbox"/>	<input type="checkbox"/>	<input type="checkbox"/>

### PREHEATING FURNACE



### STORAGE TANK

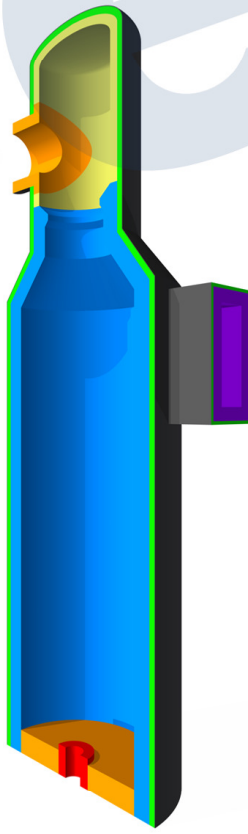

### MAIN FURNACE

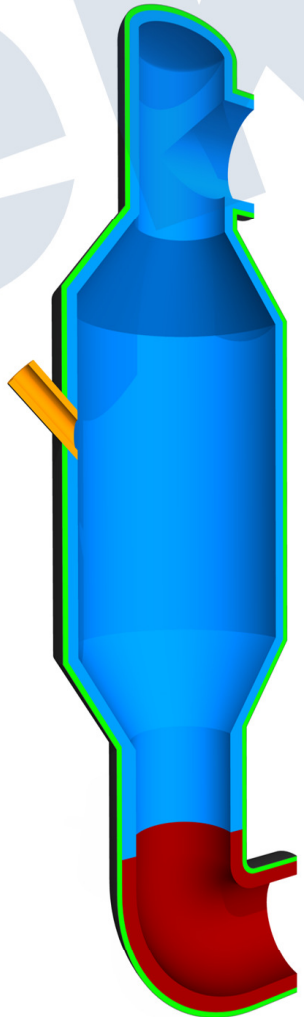

### CYCLONS

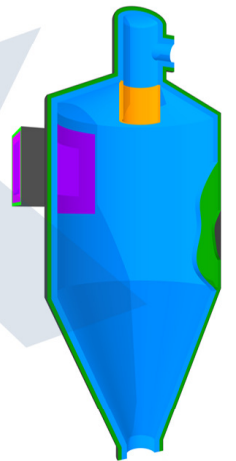

### DUCTS

