

## HORNO FUSOR Sobre nivel de metal

Pasek INSU 15/25/45 C	<input type="checkbox"/>	<input type="checkbox"/>	<input type="checkbox"/>
Pasek 65 G	<input type="checkbox"/>	<input type="checkbox"/>	<input type="checkbox"/>
Pasek 80 C	<input type="checkbox"/>	<input type="checkbox"/>	<input type="checkbox"/>
Pasek FD 85 C	<input type="checkbox"/>	<input type="checkbox"/>	<input type="checkbox"/>

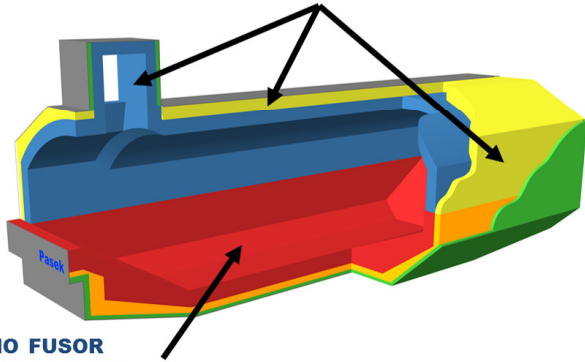

## HORNO FUSOR Bajo nivel de metal

Pasek INSU15/25/45 B G	<input type="checkbox"/>	<input type="checkbox"/>	<input type="checkbox"/>
Pasek 80 B C	<input type="checkbox"/>	<input type="checkbox"/>	<input type="checkbox"/>
Pasek FD 85 B C	<input type="checkbox"/>	<input type="checkbox"/>	<input type="checkbox"/>

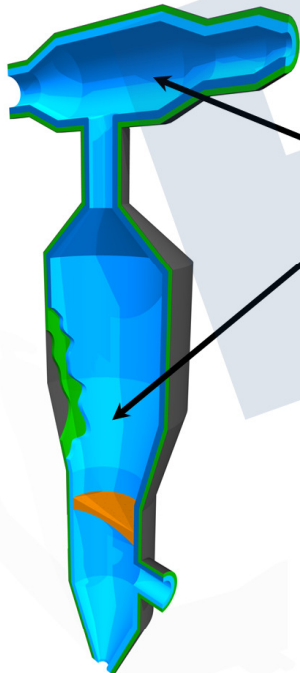

## UNIDAD SLC / DIGESTIÓN CALCINADOR y CÁMARA DE MEZCLAS

Pasek INSU 15/25/45 C/G	<input type="checkbox"/>	<input type="checkbox"/>	<input type="checkbox"/>
Pasek 85 S	<input type="checkbox"/>	<input type="checkbox"/>	<input type="checkbox"/>
Pasek 80 C	<input type="checkbox"/>	<input type="checkbox"/>	<input type="checkbox"/>
Pasek 80 HR C	<input type="checkbox"/>	<input type="checkbox"/>	<input type="checkbox"/>

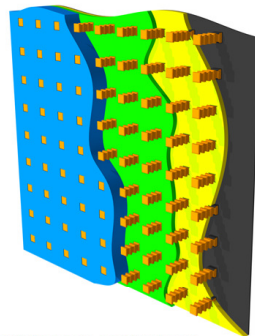
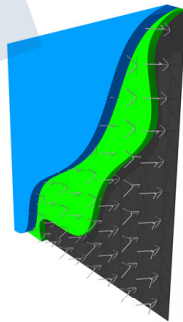

Instalación de anclajes metálicos y cerámicos

Aislantes	Aluminoso	Convencional
Gunitado/Shotcrete	Carburo de Silicio	Fast Dry
Colado/Vibrado		

## Alúmina

### UNIDAD DE CALCINACIÓN HORNO, TANQUE, CICLONES y CONDUCTOS

Pasek INSU 15/25/45 C/G	<input type="checkbox"/>	<input type="checkbox"/>	<input type="checkbox"/>
Pasek 85 S	<input type="checkbox"/>	<input type="checkbox"/>	<input type="checkbox"/>
Pasek 80 C	<input type="checkbox"/>	<input type="checkbox"/>	<input type="checkbox"/>
Pasek 80 HR C	<input type="checkbox"/>	<input type="checkbox"/>	<input type="checkbox"/>
Pasek 85 P	<input type="checkbox"/>	<input type="checkbox"/>	<input type="checkbox"/>

### HORNO de CALENTAMIENTO

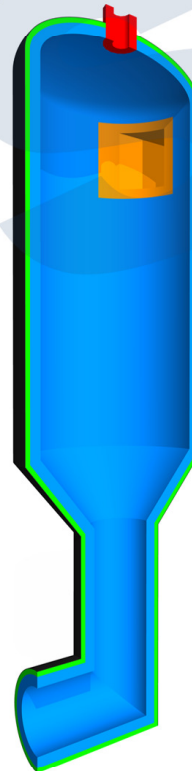

### TANQUE de RETENCIÓN

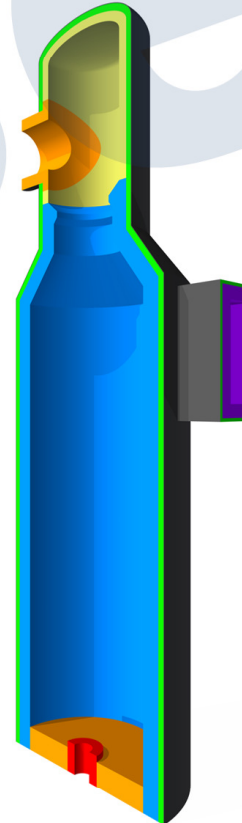

### HORNO PRINCIPAL

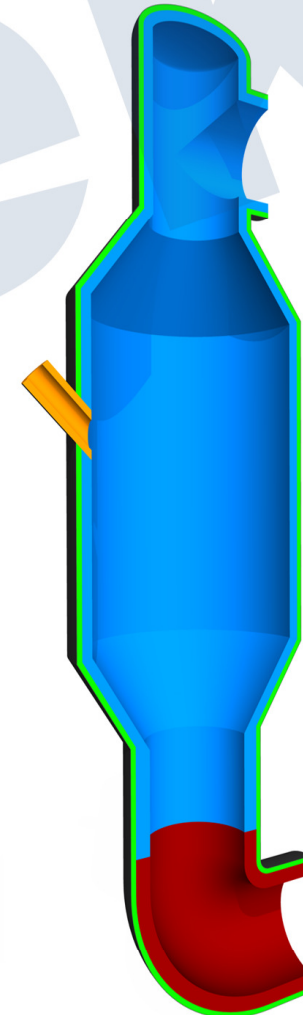

### CICLONES

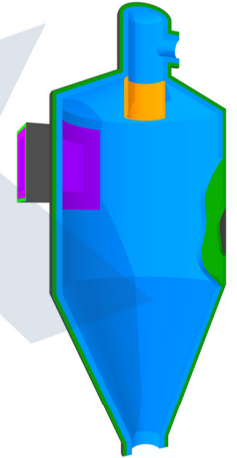

### CONDUCTOS

